

FIG. 1

TACCHE DI RIFERIMENTO PER LA
MESSA IN FASE DEL MOTORE



FIG. 2

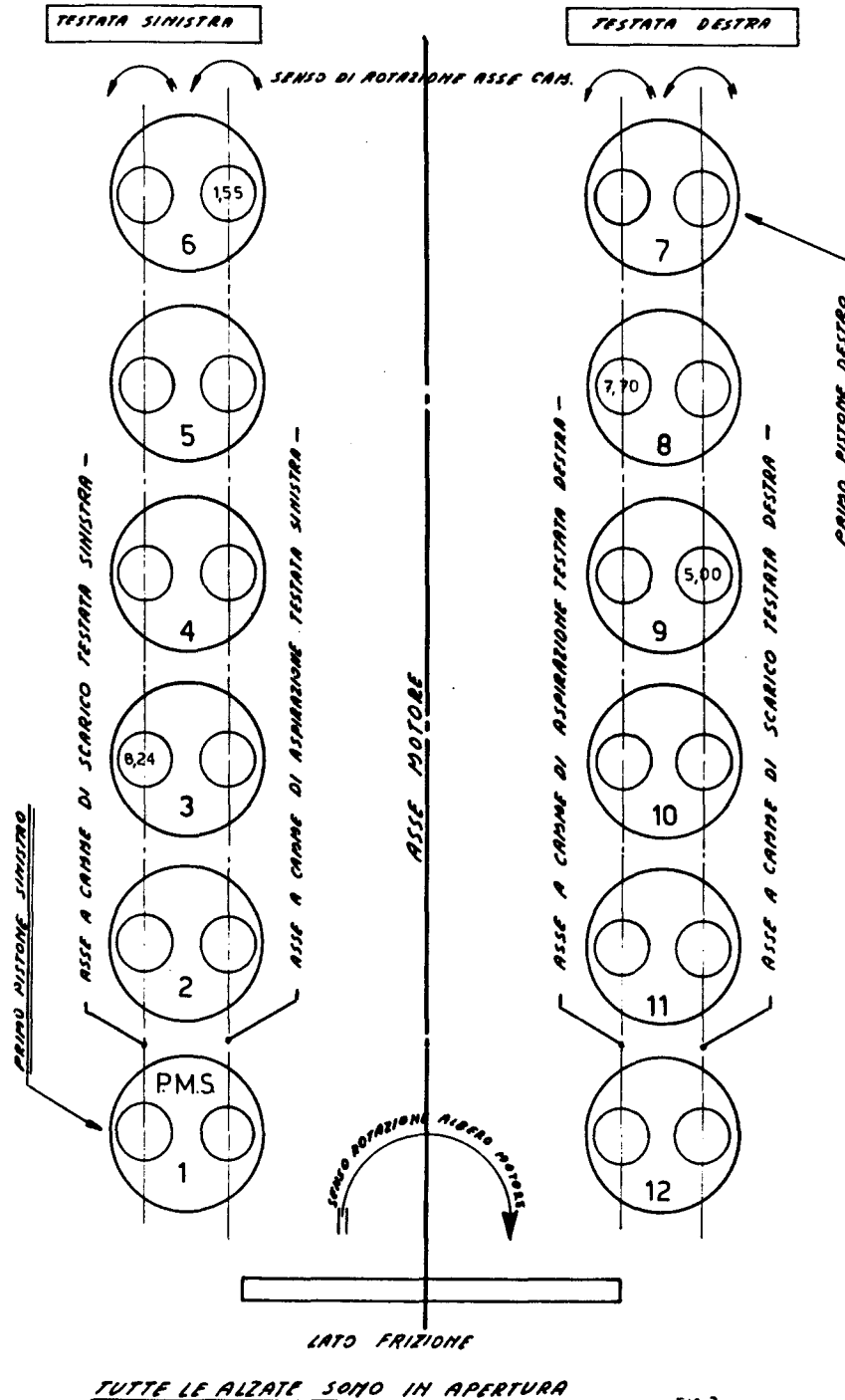

FIG. 3

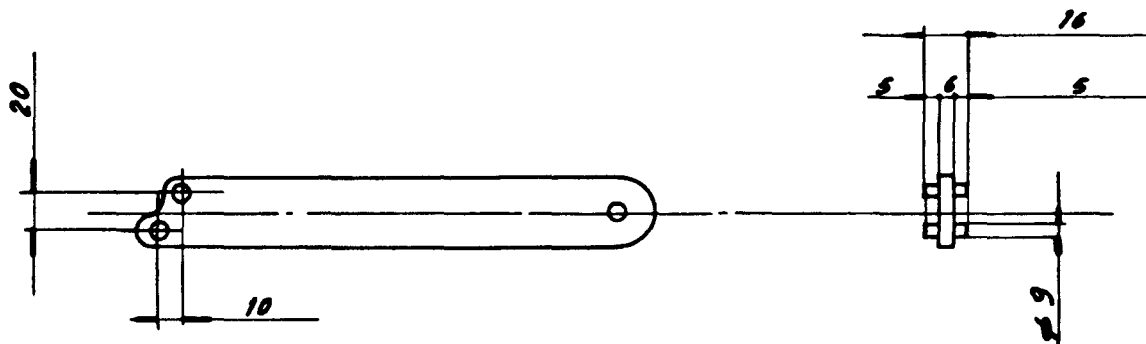

FIG. 1

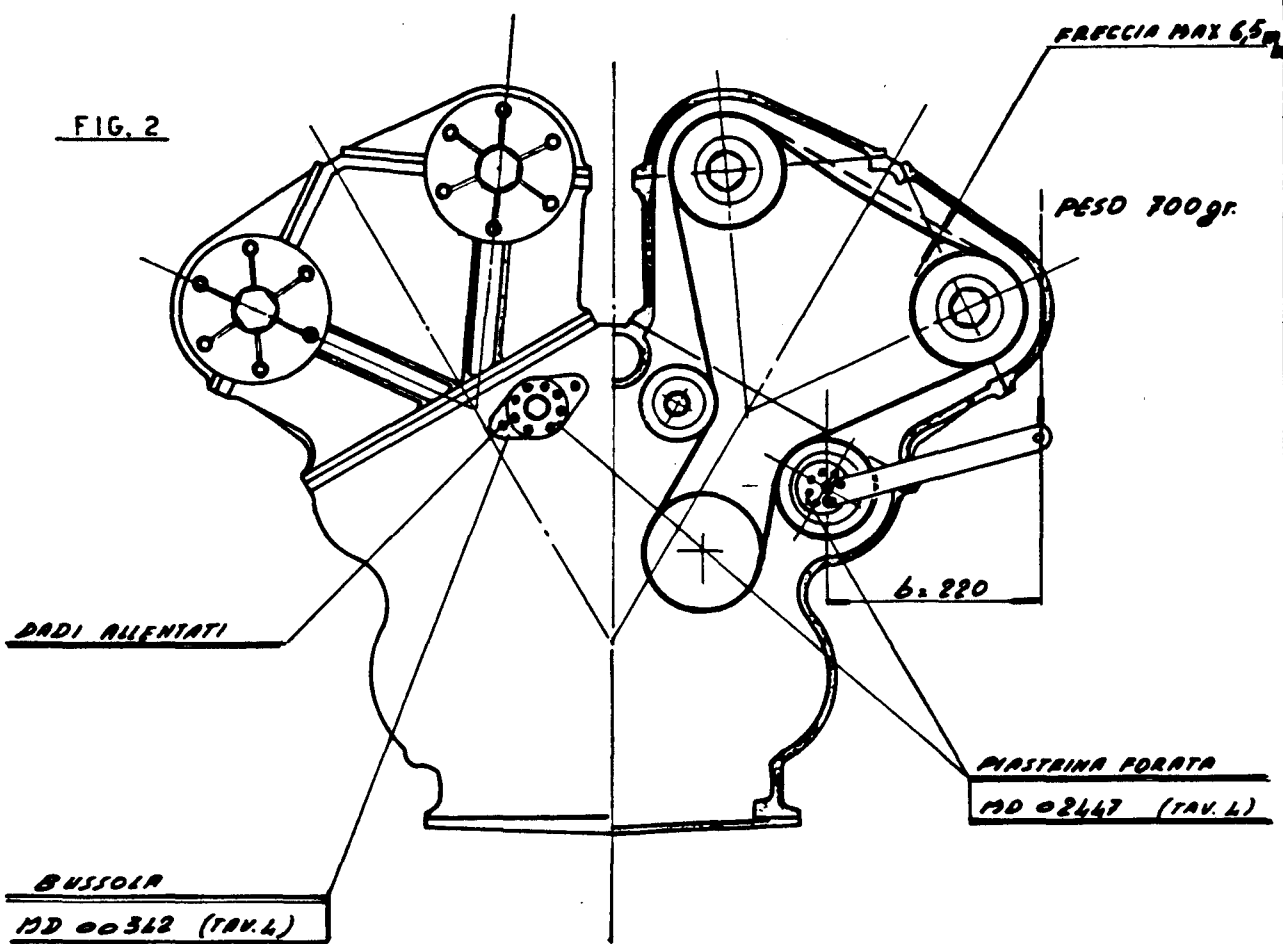

FIG. 2

DADI ALLENTATI

BUSSOLA
MD 00362 (TAV. L.)

PIASTRINA FORATA
MD 02447 (TAV. L.)

DETERMINAZIONE PUNTO MORTO
SUL PISTONE

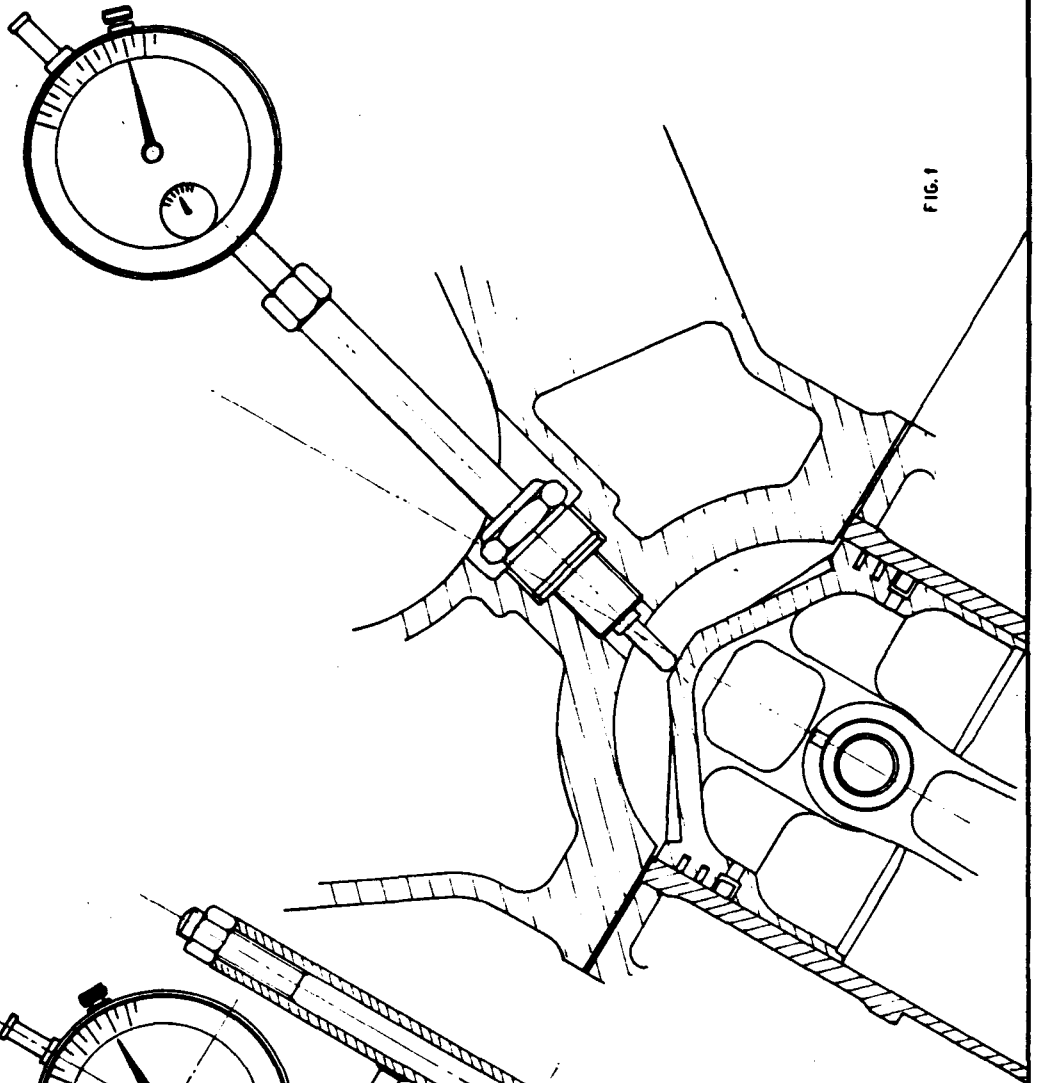

DETERMINAZIONE PUNTO MORTO
SULLA DISTRIBUZIONE

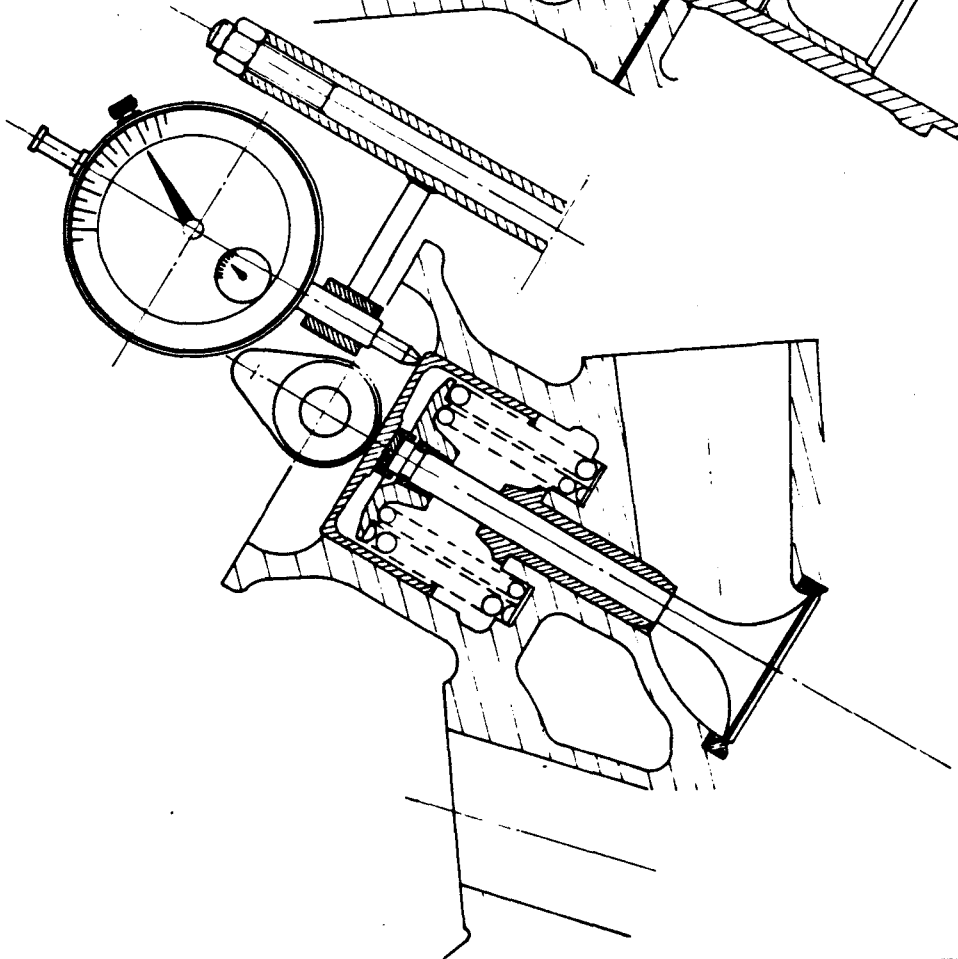

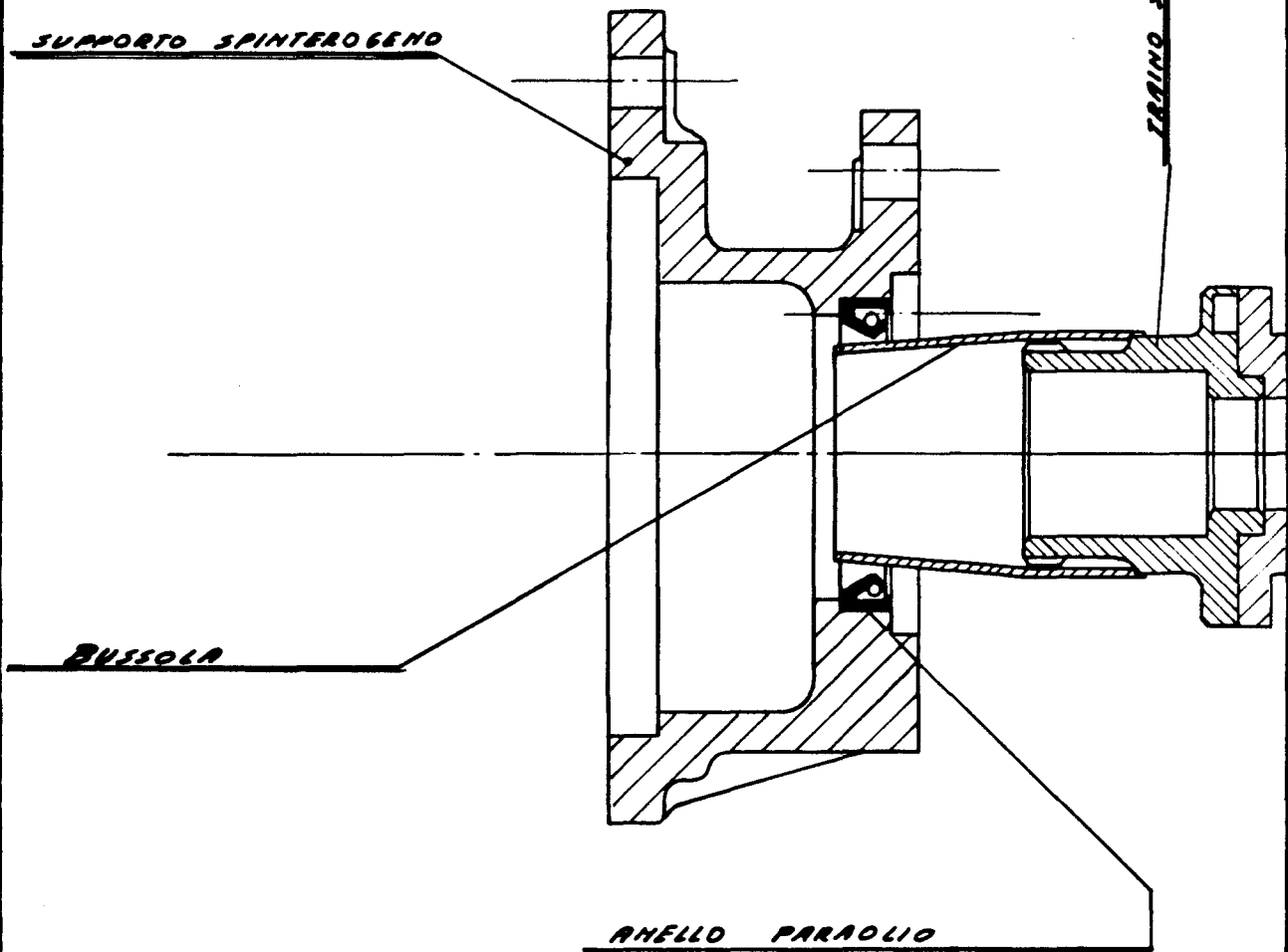
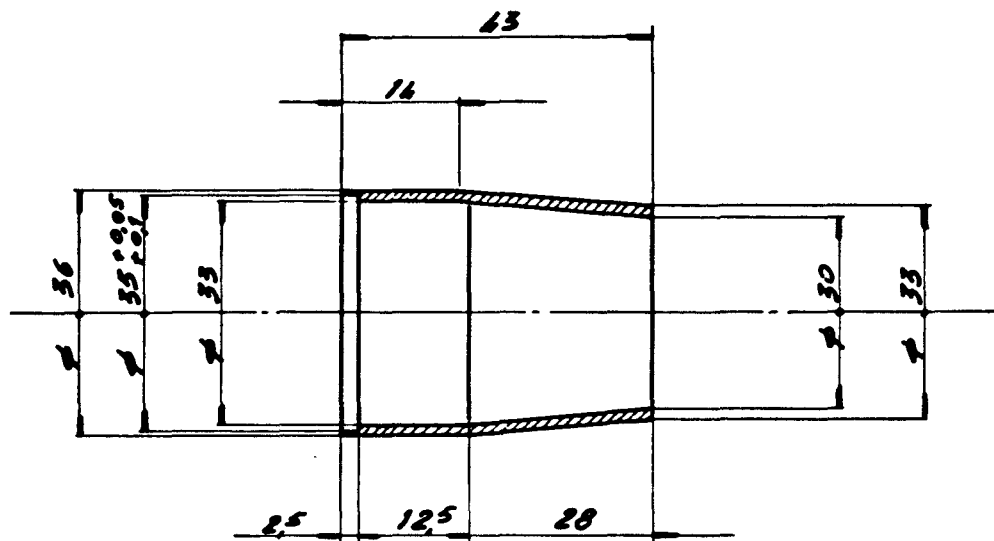

POSIZIONE DI MONTAGGIO DISTRIBUTORE BANCATA SINISTRA

FIG. 1

LA SPAZZOLA ROTANTE E' IN POSIZIONE TALE CHE IL MARTILLETTO 1 STA' PER APRIRE

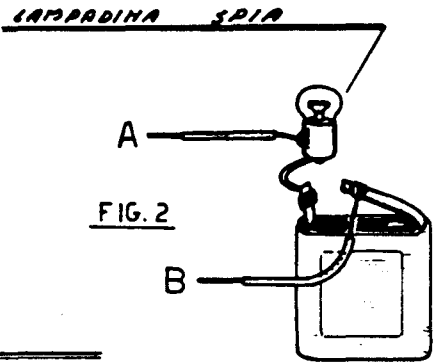
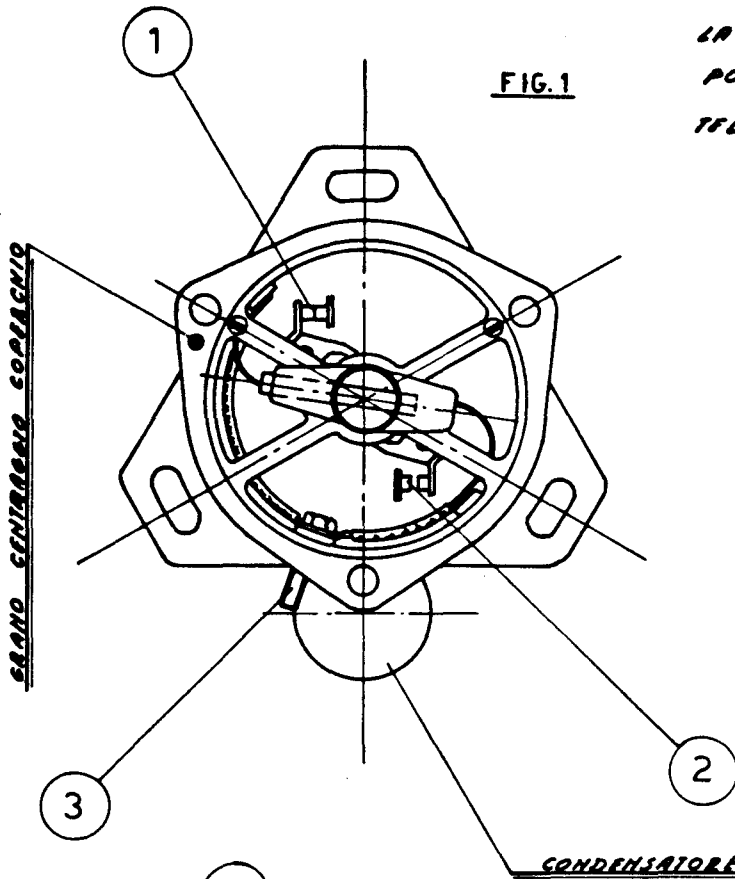

POSIZIONE DI MONTAGGIO DISTRIBUTORE BANCATA DEST.

GRANDI DI CENTRAGGIO COPRACCHIO

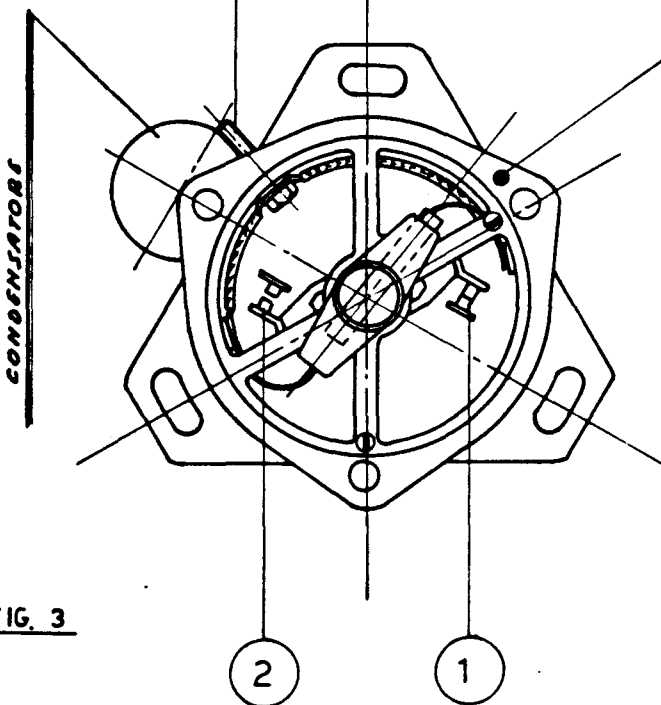

LA SPAZZOLA ROTANTE E' IN POSIZIONE TALE CHE IL MARTILLETTO 1 STA' PER APRIRE

FIG. 3

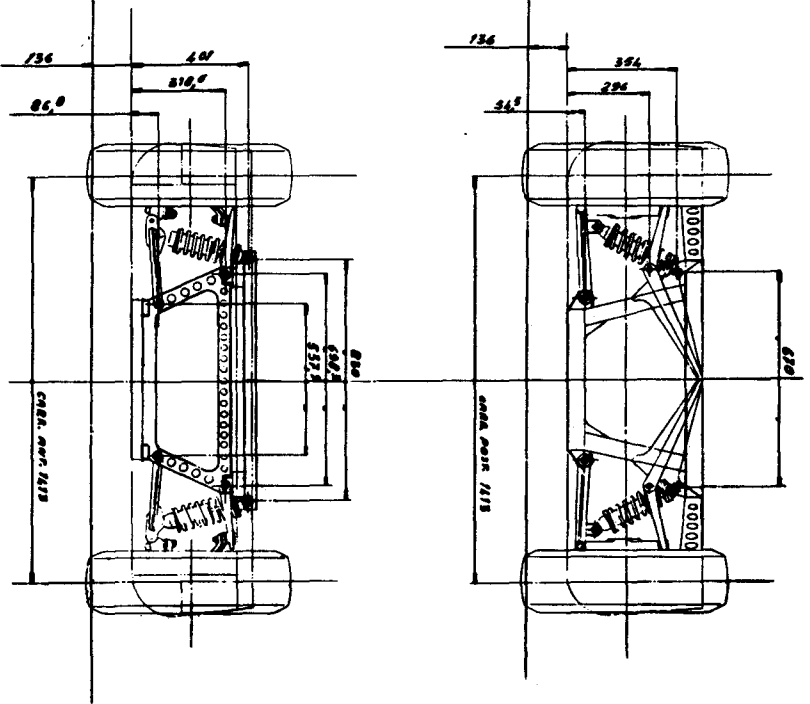
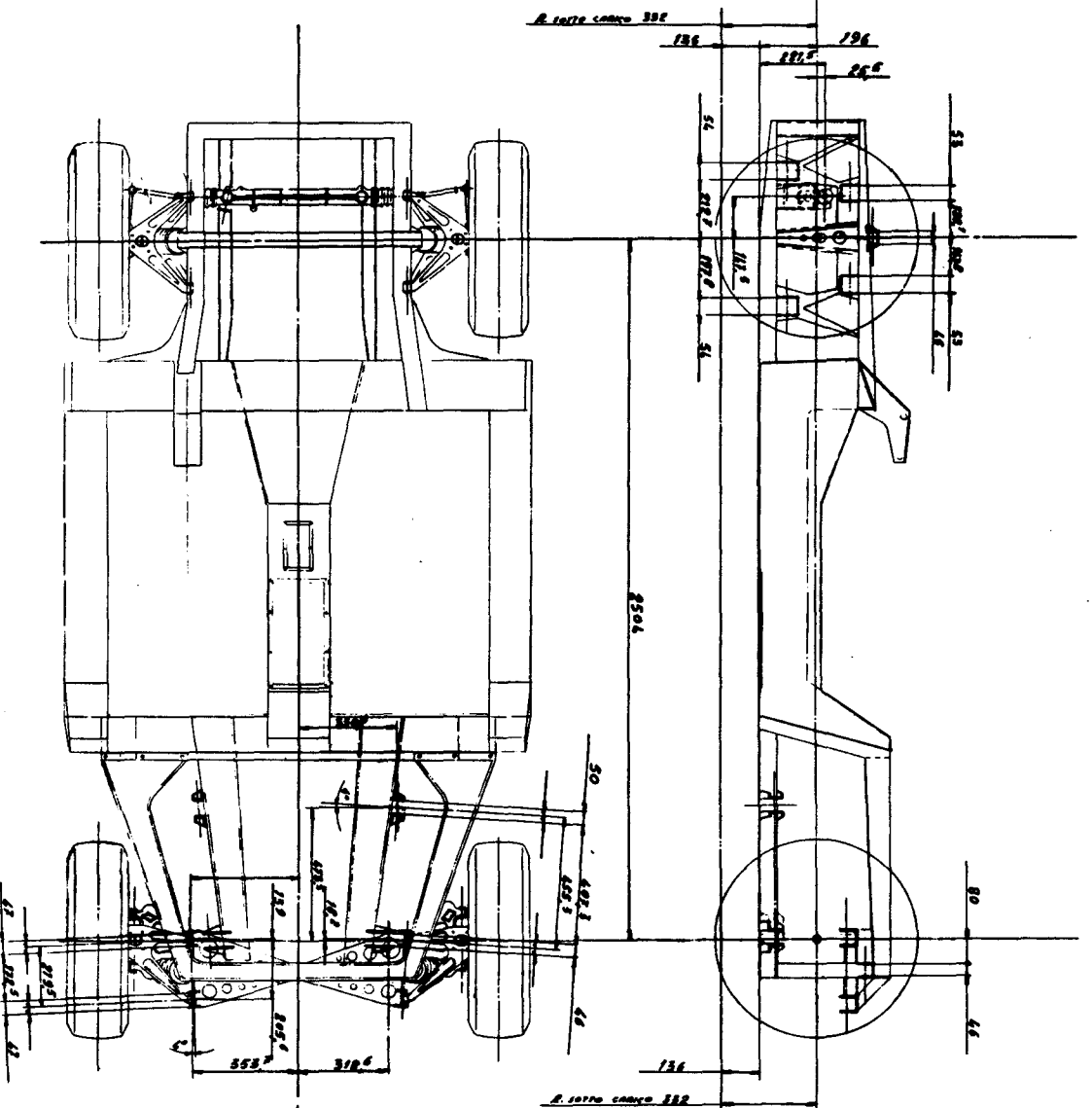

SCHEMA QUOTATURA
 AUTOTELAIO P 400-MIURA-

TAVOLA N.^o XXVIII
 LAMBORGHINI

LAMBORGHINI
P. 400 - MIURA

ANGOLI CARATTERISTICI
SOSPENSIONE ANTERIORE

TAVOLA N° XXVIII
1/4 pag. e pag.

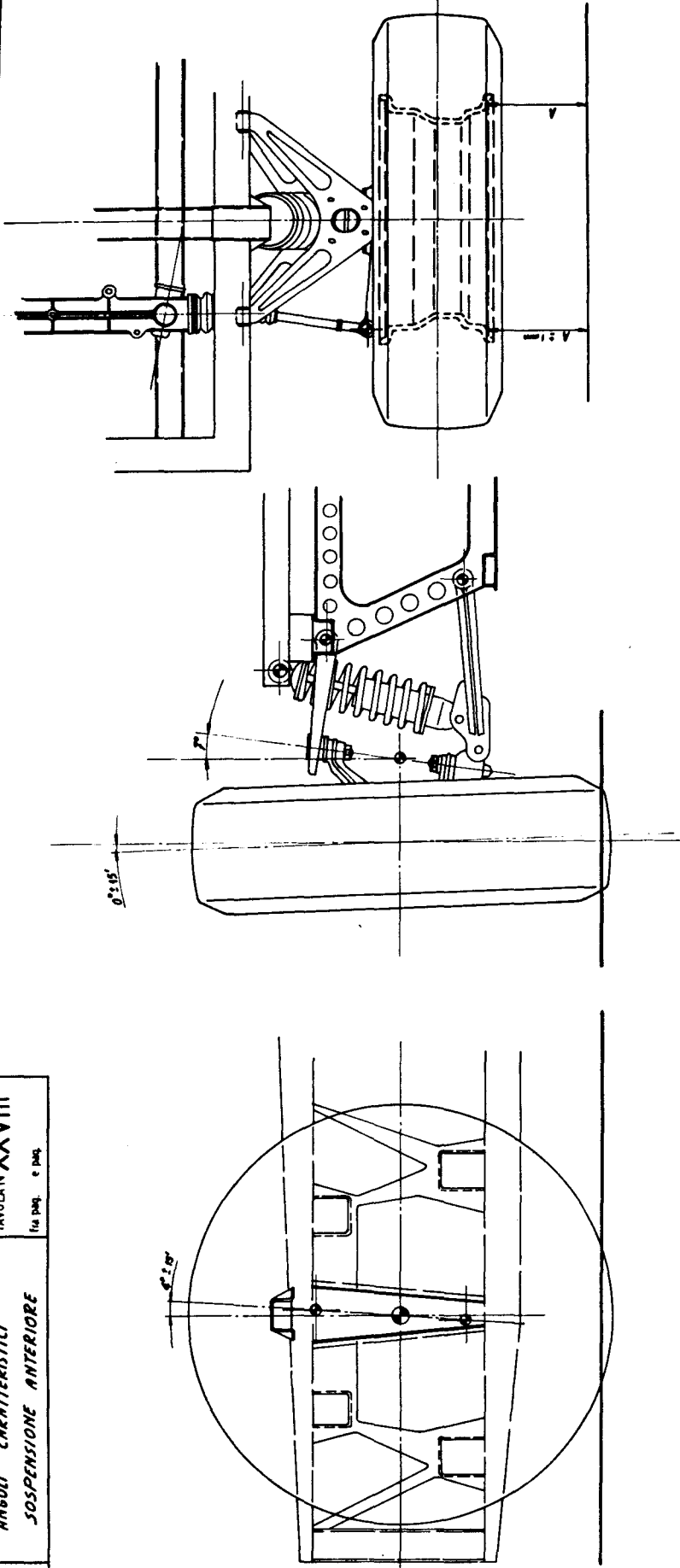

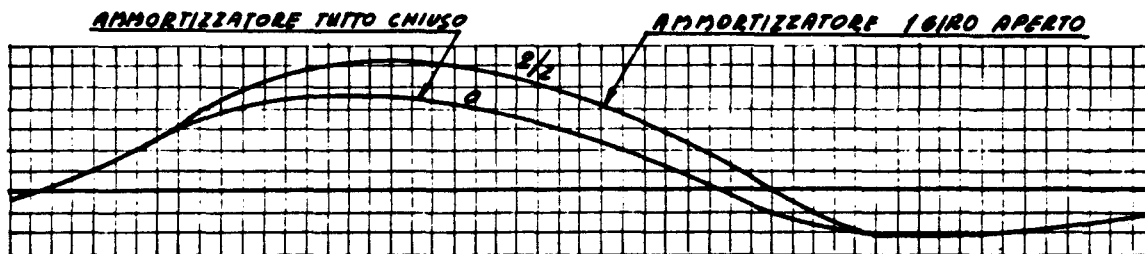
AMMORTIZZATORE POSTERIORE KONI TIPO 821583

LUNGHEZZA TAMPONE 56

BRACCIO mm. 260

TARATURA IN COMPRESIONE 40 Kg

CORSA mm. 46

TARATURA IN ESTENSIONE 120 Kg

CICLI AL 1° N° 66

MACCHINA DI PROVA "MILETTO."

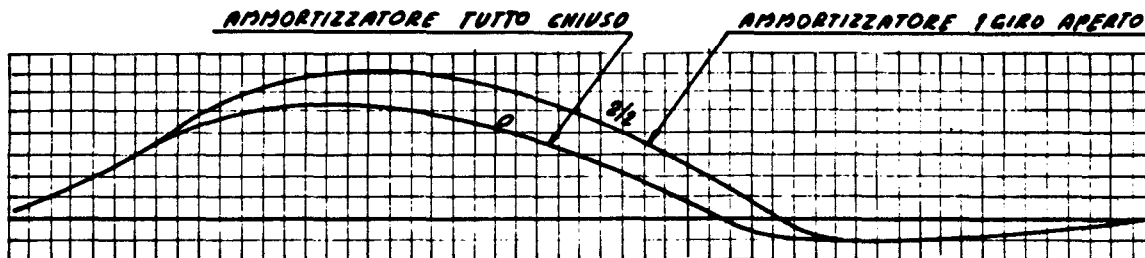
AMMORTIZZATORE ANTERIORE KONI TIPO 821582

LUNGHEZZA TAMPONE 40 mm.

BRACCIO mm 260

TARATURA IN COMPRESIONE 20 Kg

CORSA mm 46

TARATURA IN ESTENSIONE 135 Kg

CICLI 66 giri 1°

MACCHINA DI PROVA "MILETTO."

